

Connected Adapters

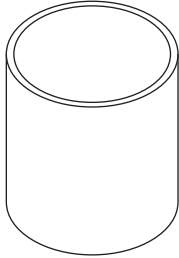

CA29503



CA29505

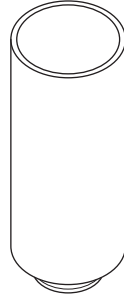

CA38355A



CA39976

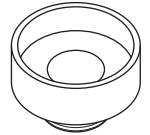

CA204508B

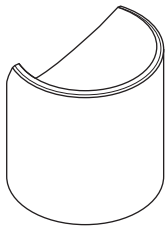

CA537499



CA538590

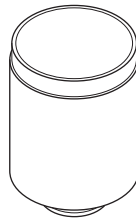

CA554413

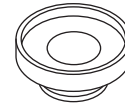

CA554414



CA554415

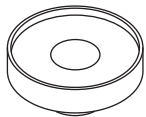

CA555380



CA555610

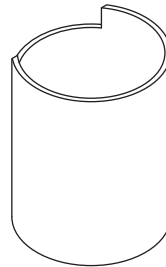

CA555613A

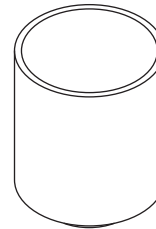

CA580523

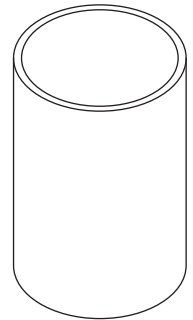

CA580524

Additional Components

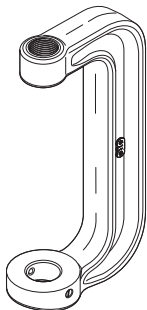

CA6636-1
C-Frame



CA6636-2
Forcing Screw

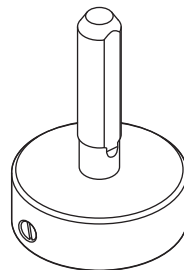

CA6636-3
Plug



29501A
Plug



39448
Thread Lube

BALL JOINT CONNECTED ADAPTER APPLICATION GUIDE

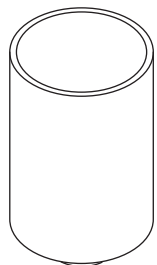

CA222305

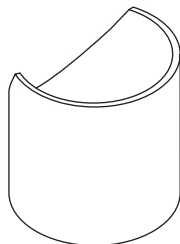

CA222306

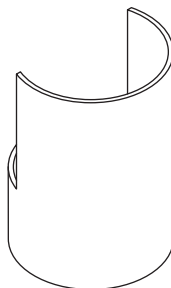

CA313444



CA313968A



CA531738



CA554417



CA554419

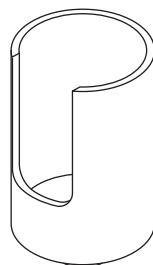

CA554592



CA555377A

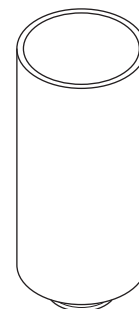

CA555379

Note: “CA” prefixed connected adapter part numbers are similar to the standard adapters in size and shape, but with the addition of the connection feature.

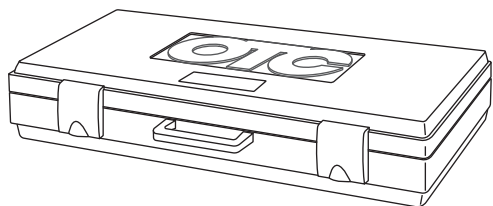

CA6630-1
Carrying Case

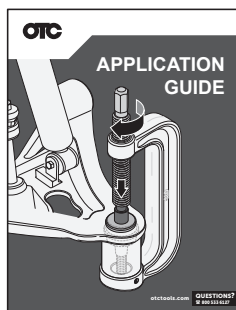

CA6630MAN-18
Application Guide

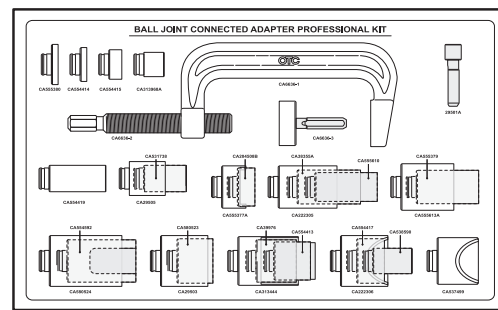

SP04516624
Laminated Card

Standard Adapters

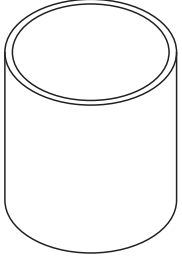

29503 * ❖

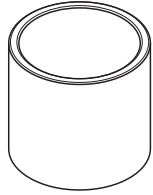

29504 * ❖



29505 * ❖

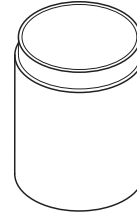

38354 * ❖

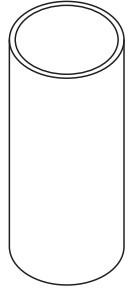

38355A * ❖

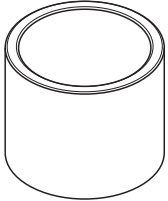

222307 ❖

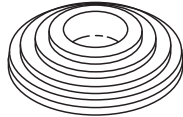

305227 * ❖

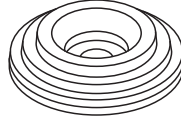

305228 * ❖

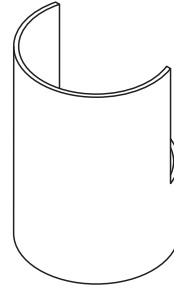

313444 * ❖

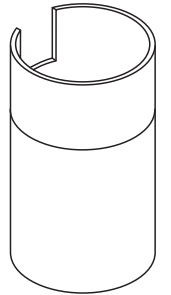

313967 * ❖

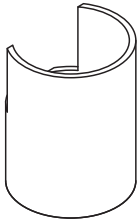

314427 * ❖

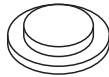

314428 * ❖

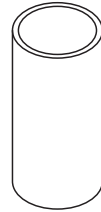

531738 * ❖



531739 * ❖

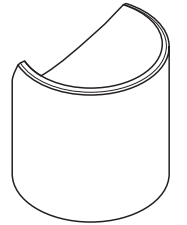

537499 * ❖

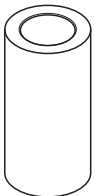

554399 * ❖



554401 *



554402 *

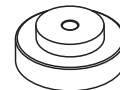

554403 * ❖



554404 *

BALL JOINT CONNECTED ADAPTER APPLICATION GUIDE

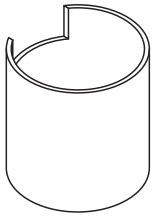

39976 * ❖

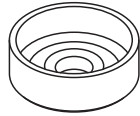

204508A * ❖



222304 ❖

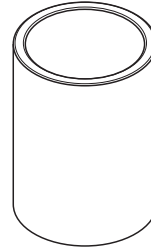

222305 ❖

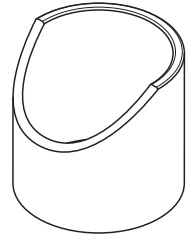

222306 * ❖



313968 * ❖

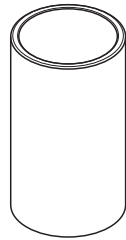

313969 * ❖

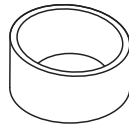

313970 ❖

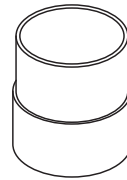

314425 * ❖

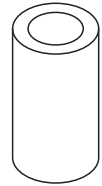

314426 * ❖

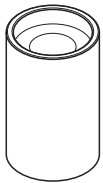

537500 * ❖

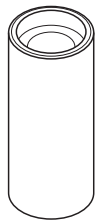

538590 ❖

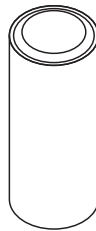

538591 * ❖

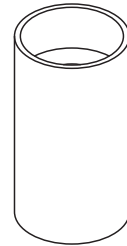

554397 * ❖

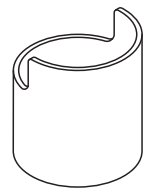

554398 * ❖

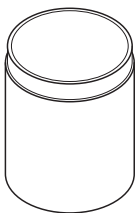

554413 * ❖



554414 * ❖



554415 * ❖



554416 * ❖

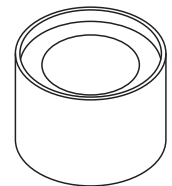

554417 * ❖

continued on next page

Standard Adapters

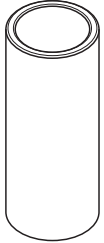

554419 * ❖



554420 * ❖

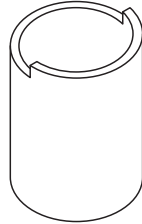

554421 *

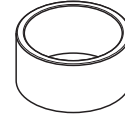

554422 * ❖

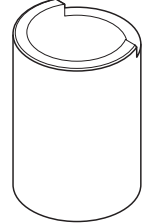

554429 *

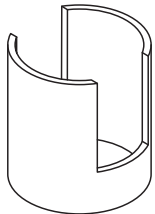

554581 *

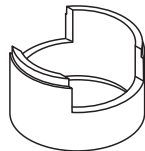

554582 *



554590 *

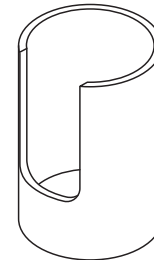

554592 * ❖



554593 *

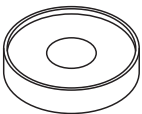

555380 ❖

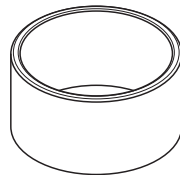

555532 ❖

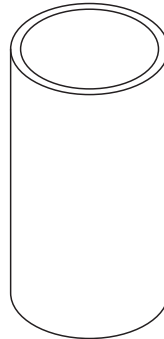

555570 ❖



555610 ❖

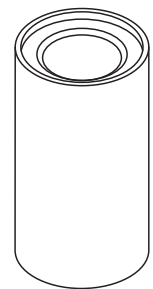

555611 ❖

Additional Standard Components

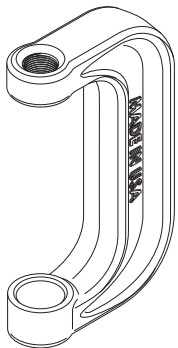

41925 * ❖
C-Frame



222395 * ❖
Screw Assembly



314392 * ❖
Plug

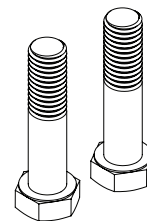

10085 *
Cap Screws
(use with 554476 & 554477)



39448 * ❖
Thread Lube

BALL JOINT CONNECTED ADAPTER APPLICATION GUIDE

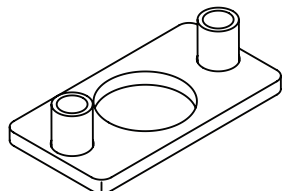

554476 *

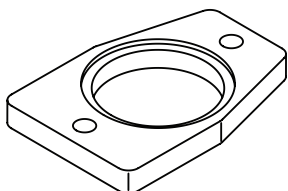

554477 *

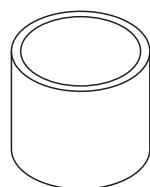

554478 * ❖

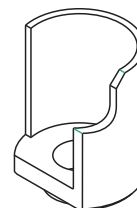

554579 *

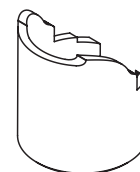

554580 * ❖



554613 ❖

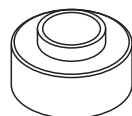

555376 ❖



555377 ❖



555378 ❖

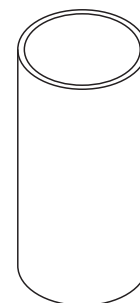

555379 ❖

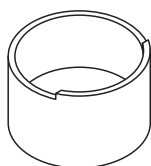

555612 ❖

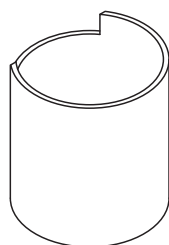

555613 ❖

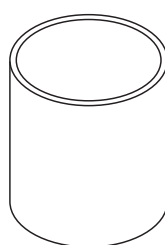

555614 ❖

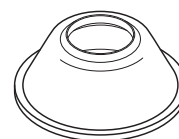

556930 * ❖

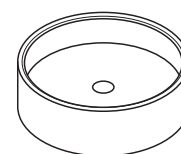

557010 * ❖

* Adapters included in OTC 6529 Car Ball JointMaster Service Kit

❖ Adapters included in OTC 6539 Truck Ball JointMaster Service Kit

Note: All 6529 and 6539 contents included in 6559 Ball Joint Master Service Kit.

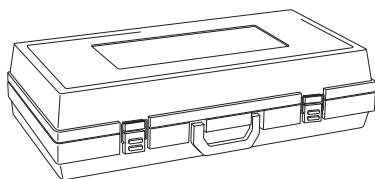

555644 * ❖
Carrying Case

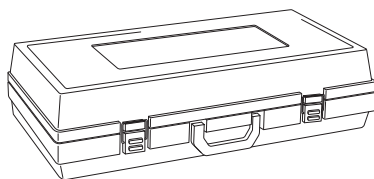

555645 * ❖
Carrying Case

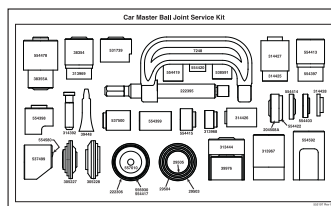

555197 *
Laminated Card

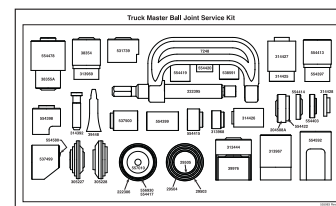

555983 ❖
Laminated Card