

Please follow the instructions to use
The machine

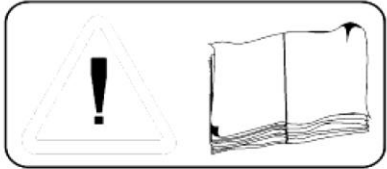

**KEEP THE MANUAL NEAR THE MACHINE ALL TIME
AND MAKE SURE ALL USERS HAVE READ THIS**



**FOLLOW THE INSTRUCTIONS CAREFULLY TO
GRANT THE MACHINE A CORRECT FUNCTION AND**

Rim Straightening Machine

*Manufacturer keeps the rights to improve the contents in this manual

XFJ-75

Notice

The manual is a main part of the product. Before using the machine, please carefully study the warnings and instructions mentioned in it, It is important for safe use and maintenance.

Note: This machine is a rim press to repair the defective rims.

The machine must be used only by the functions for which it was expressly designed, Any other use is considered wrong and unacceptable.

IMPORTANT

This machine must be operated only by the trained personnel, Any work on the electrical, hydraulic, pneumatic systems must be conducted only by professionally qualified personnel.

CONTENT

1. General notice.....	1
2. Machine description.....	2
3. Brief introduction	3
4. Problems, causes and remedies.....	4
5. Machine installation.....	5
6. Operations and use.....	6
7. Safe warnings	7
8. Machine structure.....	8
9. Daily maintenance.....	9
10. Electrical layout.....	10

Technical Characteristics

Specification

height.....900mm

length.....950mm

width.....560mm

Weight

Net weight.....240kg

noisy.....75db

Machine Description

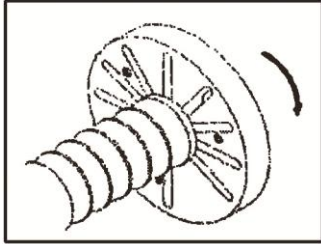

•The flange must rotate in arrow direction.

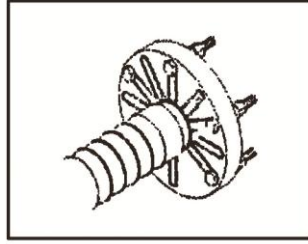

Rim connecting flange The flange is designed to serve different size rims

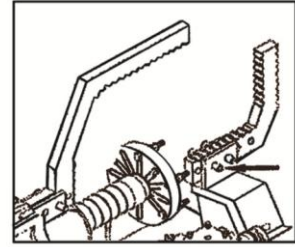

•Be sure that the support pins are mounted and Check that the piston is canal.

Safety

- Do not put your hands between the piston and be sure that the tie rim is well fixed to the flange
- Do not use the piston on living things

Instruction

This manual has been prepared for workshop personnel expert in the use of machine and technicians who are responsible for routine maintenance; Read the manual before starting any operation with the rim repairing and packing. This manual includes important information concerning:

- The safety of rim repairing machines**
- Personnel safety of operations and maintenance workers.**

Packing, Transport, Storage

The pallets must be moved with a lift truck, the equipment chosen must be suitable for safe lifting and moving Bearing in mind the dimensions, weight and fragile pares not to be damaged.

Storage

Packed machinery must always be kept in a covered, protected place at a temperature between -10°C to +40°C and must not be exposed to sunlight directly.

Packages Stacking

The type of packing allows the possibility of stacking up to 2 packages, provided they are restrained to Prevent falling, Up to 2 pallets may be stacked one upon the other on truck or in containers if properly positioned and provided they are restrained to prevent falling.

Opening crates

When the crates arrive, check that the machine has not been damaged boring transport and that all the listed parts are present. The crates must be opened using all possible precautionary

measures to avoid damaging the machine the machine or its parts. Make sure that parts do not fall from the crate during opening.

Disposal of crates

The wooden pallets and the packing film may be re-cycled.

Safety

- This machine is designed only for 10 " -26 " rims.
- This machine must be used only for rim repairing operation
- Pay attention to the warning signs on the machine

If the operator hears unusual noises or vibrations or something that may be dangerous, he must immediately button main switch off the main switch and check the section "Causers and possible remedies" in the instructions manual. if the problem is still, please call the service.

- Wearing protection glasses and gloves during operation
- Stand straight during operation

Lighting: All parts of the machine must be uniformly lit with sufficient light to assure that the adjustment areas of shadow, reflected light, glare and avoiding all situations that could give rise to eye fatigue.

- Work in an insulated and clean area
- Switch off the main switch when there is no electricity.
- Work in the safe distance
- The machine must be fixed onto smooth place.

!DO NOT STAND IN FRONT OF THE FLANGE WHEN IT IS RUNNING

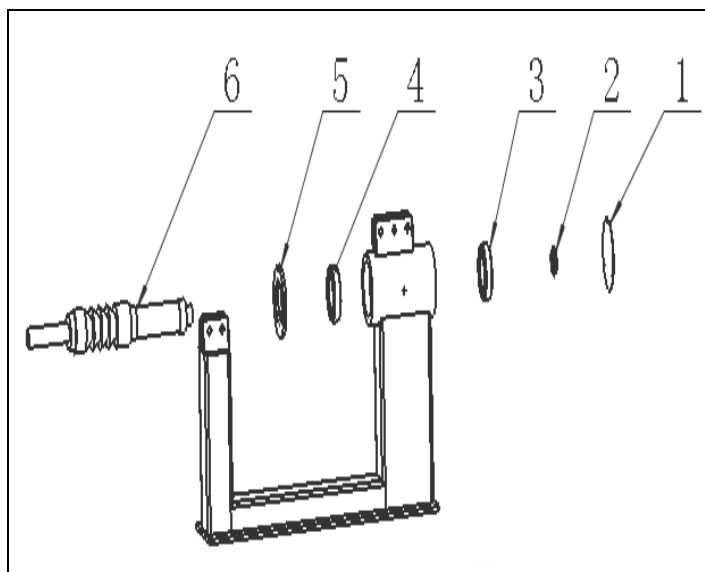

1. Take off the cover.
2. Unscrew the 3 screws of the gearbox and pull the gearbox to take it off.
3. Take off the nuts and washes.
4. Unscrew the bearings' nuts.
5. Unscrew the 3 screws of the bearings front cover and pull the bearings front cover to take it off.
6. Turn the lantern mile on the arrow side and take it off.

The flange does	<ol style="list-style-type: none"> 1. The main connection is not plugged in. 2. Faulty fuse. 3. The blog is not correctly wired. 4. The main swath is not on 	<ol style="list-style-type: none"> 1. Check the correct insertion of the plug and its connection. 2. Switch on the mains. 3. Replace the fuse.
-----------------	--	---

not rotate in any direction		
The pressure of the hydraulic unit is not enough.	<ol style="list-style-type: none"> 1. The rotation of the hydraulic engine is reverse. 2. There is leak of oil in the connection. 3. There is leak of oil in the hydraulic engine 	<ol style="list-style-type: none"> 1. Reverse the two wires in the connection plug. 2. Check the couplings, change them if necessary. 3. Filling oil to the hydraulic engine.

To fix the machine on the floor

·In order to have a good functioning, the machine must be fixed onto the floor with expansion dowels

- a. Drill the floor with a helical concrete bit with a diameter of 15mm, using the holes in the base as a drilling template.
- b. Move the rim repair and insert anchor bolts into the drills, then set the machine in the place to be fixed.
- c. Insert into the anchor bolts and use a torque wrench (setting of 25N/m) to tighten.



The turn switch machine is a clockwise toward left, the turn switch machine is the reverse toward right. Middle position for stopped state.



When machine active status revolves toward right the locking main axle, revolves toward left loosens the main axle, the main axle may revolve.

ALL WORK ON THE ELECTRICAL SYSTEM, INCLUDING MINOR OPERATIONS, MUST BE CARRIED OUT BY PROFESSIONALLY QUALIFIED PERSONNEL

- Check that the main supply is same as that shown on the registration plate.
- Connecting the cable to plug that confirms with European norms or the norm of the country in which the machine used.
- The plug must have an earth terminal.
- Check that the earth connection is effective.

- The machine must be connected to the mains through a multiple isolating switch which confirms with European norm and with contact openings of at least 3mm.
 - Check that multiple connector on the electrical board is correctly connected.
 - When the machine is connected, switch it on and check the check the correct direction of rotation; this should be as shown by the arrow on the motor unit.
 - If the rotation is reversed, reserve the two wires in the connection plug.
 - If the machine operates abnormally, immediately press the emergency button and switch off the main switch and check the section of "Causes and possible remedies" in the instruction manual.
- THE MANUFACTURER DOES NOT ACCEPT ANY RESPONSIBILITY FOR THE FUTURE TO OBSERVE THE ABOVE MENTIONED INSTRUCTIONS

Operations and Use

Connecting to the defective rim to the flash

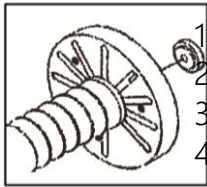

1. Clean the mud and the balance weights from the rim.
2. Choose a suitable sized connecting flange for the rim.

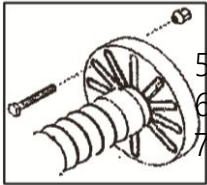

3. Tight the nuts to start repairing.
4. Tight the connecting flange and fasten to the suitable canals on the flanges.

Analyzing the defective area

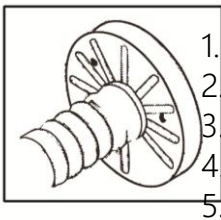

1. Rotate the flange.
2. Locate the defective area by using gauge and mark it.

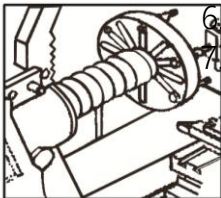

3. Tight the nuts to start repairing
4. Choose a suitable support and repair it.

Rim repairing positions

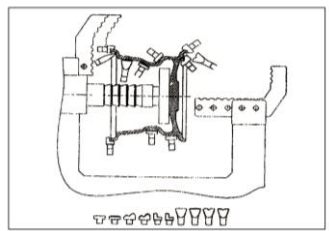

Operation and Use
Some examples of repairing

Operation and Use

When repairing iron rims use also the manual handle plus to the pressing.
 Before the pressing operation, some rims need to be heated (especially aluminum rims).

This procedure is for;

1. Avoiding cracks and faults on the rim.
2. Piston's safety.
3. Your personnel safety

If the rim is defected much, first mend it with the lever and then it with pressing.

Lathe Operation

Tight the fixing handles during lathe operation

Uptight the nuts during lathe operation

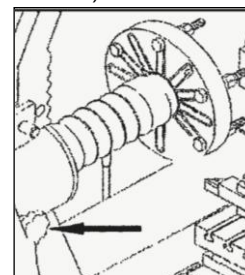

Daily Maintenance

To guarantee the efficiency of the machine and for its correct functioning is essential to carry out the routine cleaning and maintenance.

Routine starting any cleaning or maintenance, switch off the main switch and remove the main plug from socket.

Every day

Clean and grease the flange and lathe.

Every month

Check the oil level of the hydraulic unit.

Every 6 months

Grease the bearings and make a general check.

Every year

General check: Visual inspection of all structural parts and mechanisms to guarantee that there are no problems.

Electric plant. Skilled electricians should test the electric plant. Storage

Periods of in activity	Permanent Storage
The machine is temporarily stored or Whenever the machine is not in use, Remove the plug from the mains	If it is decided to store the machine long term, it is advisable to make it inoperative by removing the mains cable after having unplugged it from the mains.

THE CHNICAL ASSISTANCE AND SPARE PARTS

·The machine is guaranteed(1 years); The relevant certificate of guarantee is supplied with the machine.

·For any machine of functions, consult the section "Causes and possible remedies" Any other functions must be checked by professional qualified personnel.

·In all cases contact the assistance service of Xi'an Said, For prompt assistance it is important at the time of call to specify the machine model, The production No.(pals find it the registration plate)and type of trouble.

WARNING

Any work on the electrical, hydraulic and pneumatic systems must be carried out any by

PROFESSIONALLY QUALIFIED PERSONNED.



The motors are not under guarantee.

WARNINGS

Use only original of machine.

We do not take responsibility of non-original parts

Electric layout

POWER SUPPLY:1×110V AC+PE 50Hz-60Hz

1×220V AC+PE 50Hz-60Hz

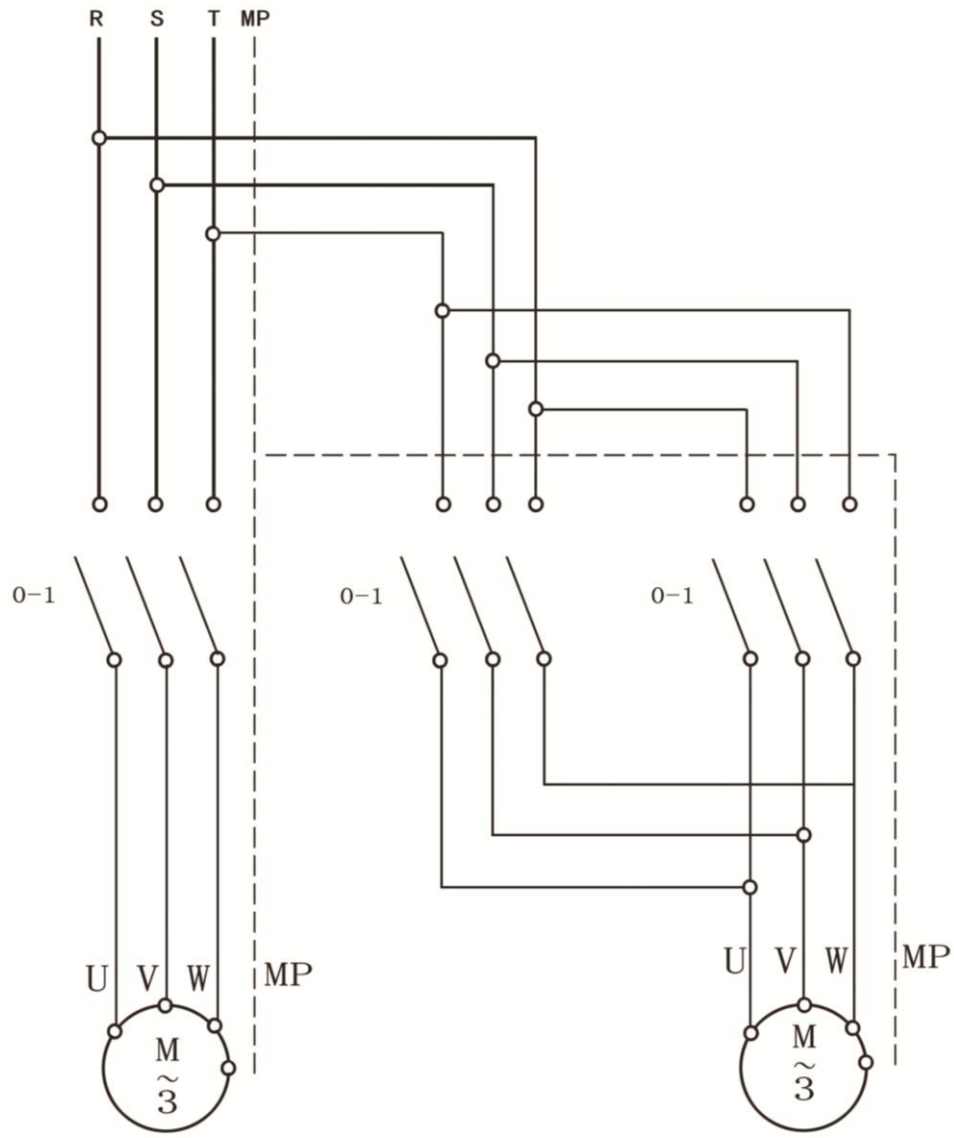

HYDRAULIC ENGINE

REDUCTON ENGINE

Electric layout

POWER SUPPLY: 1×380V AC+PE 50Hz-60Hz

1×220V AC+PE 50Hz-60Hz

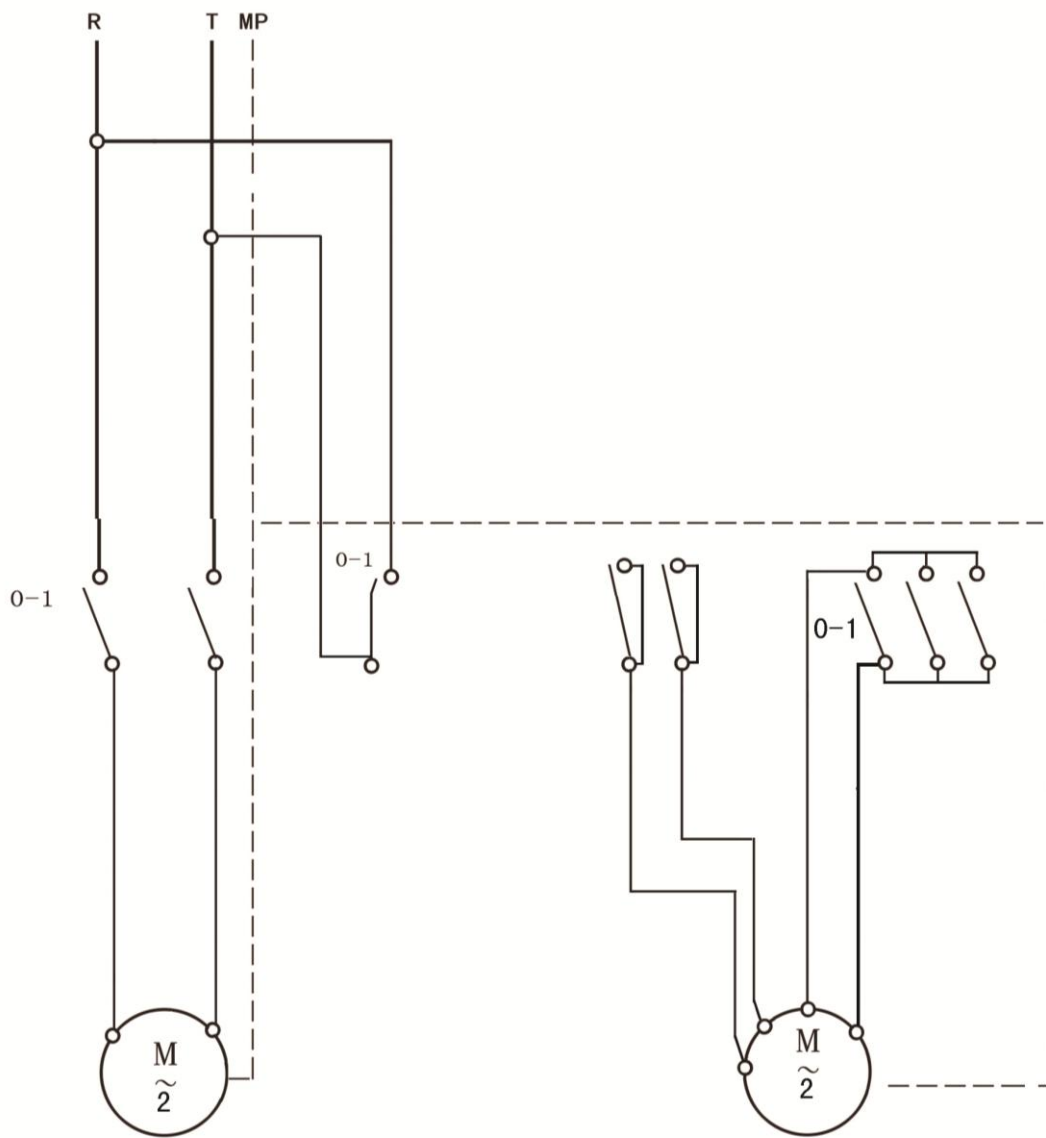

HYDRAULIC ENGINE

REDUCTON ENGINE